

HYBRID STEPPER MOTOR BALL SCREW ACTUATOR



- **Motor characteristics**

Motor	Voltage (v)	Current (A)	Resistance (Ω)	Inductance (mH)	Lead wire no.	Motor length (mm)
ACT1133-10-B100	2,1	1,0	2,1	1,5	4	33,5
ACT1145-09-B100	3,9	0,95	4,1	4,0	4	45

- **Ball Screw Specifications**

Ball Screw Type	0601	0602	0606	0610	0504								
Ball Size	∅0,8	∅0,8	∅0,8	∅1,2	∅0,8								
Number of Thread	1	1	2	2	1								
Thread Direction	Right												
Shaft Root Diameter	∅5,3	∅5,1	∅5,2	∅5,0	∅4,3								
Number of Circuit	3,7x1	2,7x1	1,6x2	1,2x2	2,7x1								
Shaft, Nut Material	SCM415H												
Surface Hardness	HRC58-62												
Anti-Rust Treatment	Anti-rust Oil												
Grade	C7												
Nut Size	A	B	C	D	H	W	X	E	Position Accuracy	Total Run Out	Axial Play	Dynamic Load (N)	Static Load (N)
0601	26	4	17	13	16	20	3,4		±0,05	0,12	0,02	680	1200
0602	28	4	17	15	19	22	3,4		±0,05	0,12	0,02	750	1450
0606	27	4	17	14	16	21	3,4	5	±0,05	0,12	0,02	870	1600
0610	27	4	23	14	16	21	3,4	7,5	±0,05	0,12	0,02	950	1650
0504	24	4	22	12	16	18	3,4		±0,05	0,12	0,02	470	720

• Dimensional Drawings

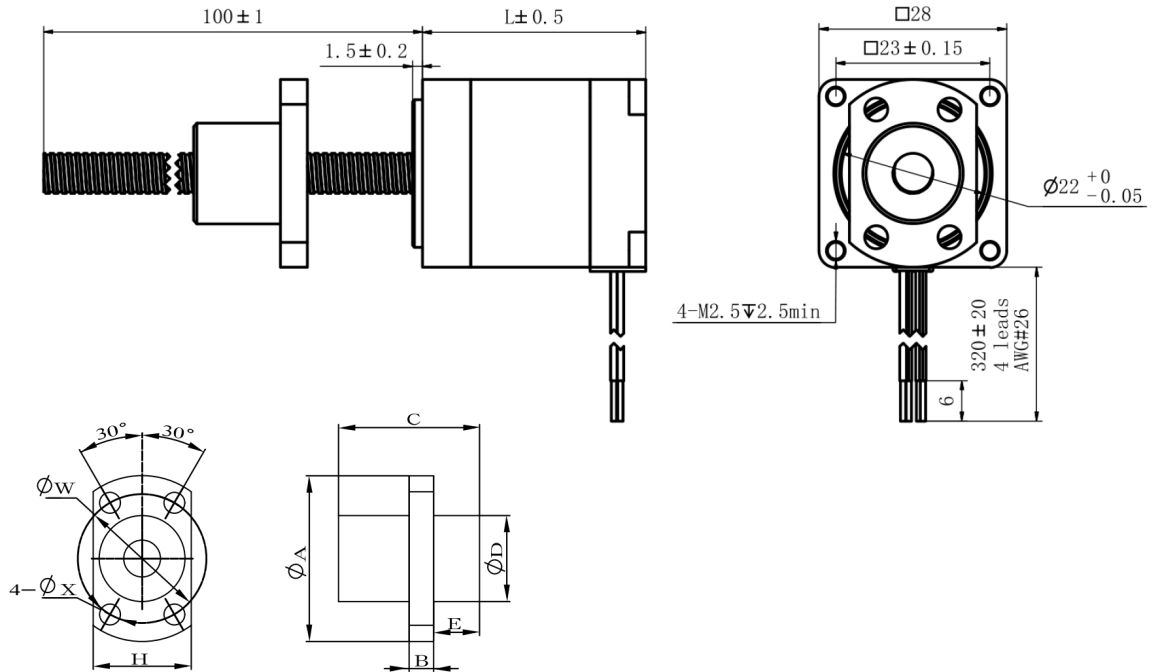

• Speed Thrust Curves

